

GPR-2000

Direct type	Pilot type	Diaphragm	Piston
Bellows	Internal sensing	External sensing	Stainless steel
Nylon	Low pressure	DP regulating	Pressure sustaining

■ Features

1. Large capacity and distinguished performance.
2. Excellent sealability ensured by spherical valve.
Distinguished durability of stainless steel made valve and valve seat.
3. Wide range pressure adjustment.



Screwed type



Flanged type

■ Specifications

Application		Steam	
Primary pressure sensing method		External sensing type *1	
Pressure regulating range		0.02-0.15 MPa *2	
		0.1-1.1 MPa	0.1-1.0 MPa
		1.0-1.4 MPa	-
Minimum differential pressure		15% of set pressure (gauge pressure) (Minimum value: 0.10 MPa)	
Fluid temperature		220°C or less	
Valve seat leakage		0.01% of rated flow rate	
Material	Body	Ductile cast iron (FCD450)	
	Main valve	Stainless steel	
	Valve seat	Stainless steel	
	Pilot valve	Stainless steel	
	Pilot valve seat	Stainless steel	
	Diaphragm	Stainless steel	
Connection		JIS Rc screwed, JIS 20K RF flanged	JIS 10K FF flanged

*1 External sensing method is used for the product because of controllability (performance). Available with internal sensing type, but the Cv value is different.

*2 When the set pressure is between 0.02 MPa and 0.1 MPa, back pressure should not exist.

■ Dimensions (mm) and Weights (kg)

• Screwed type

Nominal size	d	L	H ₁	H	A	Weight
15A	Rc 1/2	150	170	398	200	14.5
20A	Rc 3/4	150	170	398	200	14.5
25A	Rc 1	160	175	404	226	18.8
32A	Rc 1-1/4	180	192	434	226	22.0
40A	Rc 1-1/2	180	192	434	226	22.0
50A	Rc 2	230	216	498	276	33.6

• Available with NPT connection.

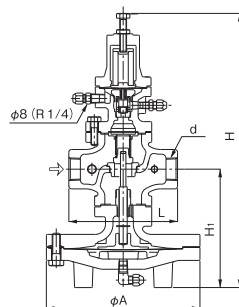

• Flanged type

Nominal size	L	H ₁	H	A	Weight
15A	146 (142)	170	398	200	16.0 (15.8)
20A	146 (142)	170	398	200	16.5 (16.3)
25A	156 (152)	175	404	226	21.5 (21.1)
32A	176 (172)	192	434	226	24.5 (24.0)
40A	196 (192)	192	434	226	25.0 (24.6)
50A	222 (218)	216	498	276	36.6 (36.4)
65A	282 (278)	251	552	352	64.9 (64.6)
80A	302 (294)	264	575	352	72.1 (69.9)
100A	342 (330)	321	658	401	111.6 (108.0)

• The values in parentheses are the dimensions and weights of JIS 10K FF flanged.

• Please contact us for flanged type other than the above.

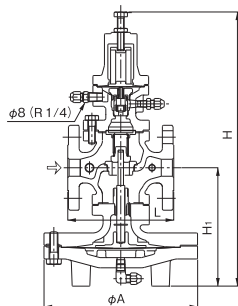

Specifications Chart

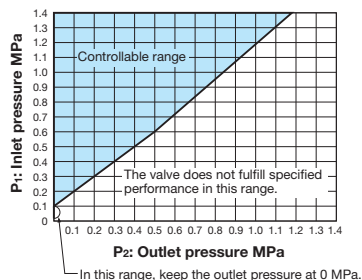

Flow Rate Characteristics Chart

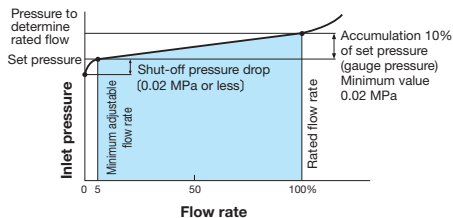

■GPR-2000 Nominal Size Selection Chart (For Steam)

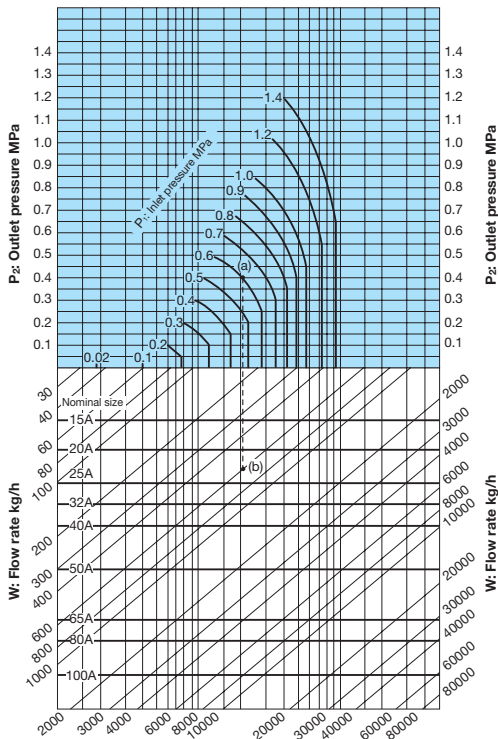

[Example]

When selecting the nominal size of a primary pressure regulating valve whose Inlet pressure (P₁), outlet pressure (P₂), and flow rate are 0.6 MPa, 0.4 MPa, and 600 kg/h, respectively, first find intersection point (a) of the Inlet pressure of 0.6 MPa and the outlet pressure of 0.4 MPa. Trace down vertically from this intersection point to find intersection point (b) with the flow rate of 600 kg/h. Since intersection point (b) lies between nominal sizes 20A and 25A, select the larger one, 25A.